

ROADWAY LUMINAIRE



Roadway Round With Circline Bulb

Features:

- High pressure die cast aluminum alloy housing for corrosion resistance.
- Flat tempered glass lens.
- High purity aluminum reflector with vacuum coated inner surface.
- Optional photocell.
- Timer dimming function available upon request.

Lamp and Ballast:

- Miller's 70W~100W round tubular induction lamp features high lighting efficacy, long lifetime, good color rendering, stable output, etc.
- Miller's electronic ballast features high power factor (>0.95), flickering free, low loss, constant output, etc.

Applications:

- Freeway, highway, parking lots, public entrances, off-street area.



Dimensions:

Unit:in.(mm)

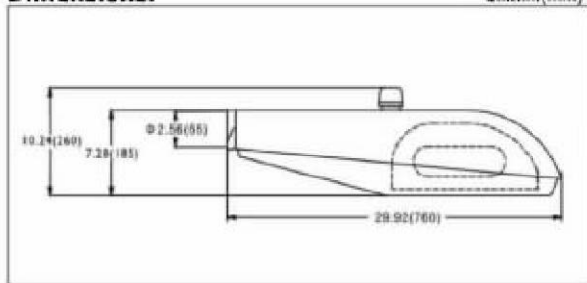

◆ Photometric:

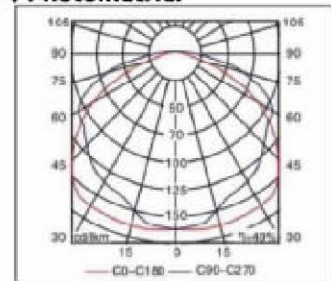

Fixture Specification:

Product No.	Fixture Model No.	Lamp	Wattage (W)	Voltage (V)	Color Temperature (K)	Ambient Temperature (°C)	Installation	IP class	Note	UL CUL
RL70PE	RL70-R		70	120~277	5000	-20°C~+40°C	Round Pole	IP55	Optional Photocell	✓
RL85PE	RL85-R	80								
RL100PE	RL100-R	100								✓